

## Durham Trinity School & Sports College

### Additional information for the Headteacher vacancy

#### We moved in to our new school in November 2014

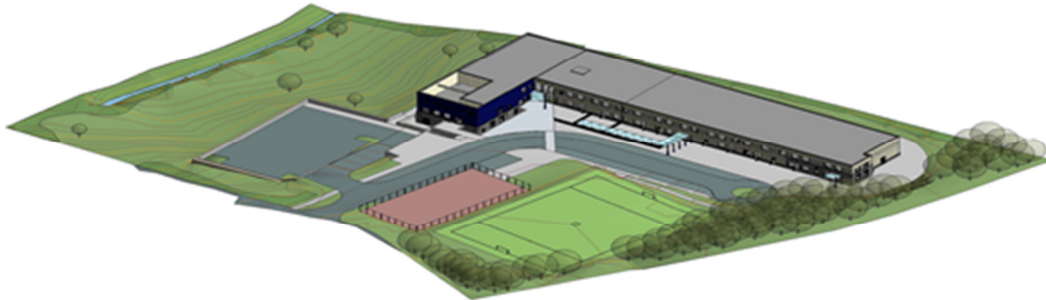

**Would you like to be the Headteacher in this purpose built environment? If so, read on.**

It has brought together the 3 sites of the school in 1 building.

Our new school building accommodates:

- Nursery, KS1 & KS2 classes, all ages of specialist ASD provision, all ages of sensory provision on the ground floor. Each class has direct access to their outdoor learning space.
- Secondary pupils and Post 16 pupils on the first floor. Specialist teaching rooms are located on this floor.

There are 2 dining areas on the ground floor. One is used by primary pupils and the other by secondary pupils. The multi-purpose hall is timetabled for PE lessons throughout school.

The design of the building has embraced the gradient of the site and there is a small lower ground floor area. The small swimming pool is located on this level along with a variety of rooms for visiting professionals and school based staff.

Externally there is a MUGA, a sports field, a meadow with trim trails and fruit orchard, carpark.

We are a popular generic special school catering for pupils aged 2-19. Currently there are 213 pupils on roll. This will rise to 220 as the new provisions in the new school build become established.

We have a diverse staffing complement:

Headteacher Deputy Headteacher 2 Assistant Headteachers Director of Sport SENCO EYFS/KS1&2 Leader KS3 Leader KS4 & Post 16 Leader 20 Teachers Swimming Instructor 2 HLTA's 35 (31.7fte) Teaching Assistants 3 (2.5fte) Health Care Education Assistants 6 Welfare Assistants PE apprentice	School Business Manager 4 clerical staff 1 business & admin apprentice ICT Network Manager  Parent Support Advisor	2 caretakers 1 cleaner-in-charge / groundsman handy person 7 cleaners Housekeeper
--	---	---

In addition we have a variety of agencies working regularly in school including physiotherapist, occupational therapist, speech & language therapists, LA specialist support services (MDSI, VI, HI), school nurse service, educational psychologist, education welfare officer, social workers and CAMHS personnel. This is not an exhaustive list.

**Breakdown of current pupil population:**

Year Group	No. of pupils
Pre	2
N	3
R	9
1	12
2	14
3	10
4	11
5	13
6	15
7	16
8	25
9	19
10	16
11	19
12	8
13	11
14	10

**Organisation of classes: The school has 23 classes.**

<b>Provision</b>	<b>No of classes</b>	<b>Curriculum delivered by:</b>
Specialist autistic provision classes (R-Y2, Y3-Y6, Y7-Y9, Y10-Y14)	4	Class teacher delivers all subjects except swimming, PE and music. These are delivered by specialist subject staff
Sensory provision classes (Pre- R, Y1-Y6, Y7-Y14)	3	
EYFS/KS1	2	
KS2	4	
KS3	5	
KS4	3	KS3 & KS4 skills groups mainly taught by class teacher, with some specialist teaching input. KS3 nurture group, KS3 & KS4 'mainstream' tutor groups are taught by specialist subject teachers.
Post 16	2	Mainly delivered by FE staff with some subject specialist teacher input

The school website [www.durhamtrinity.durham.sch.uk](http://www.durhamtrinity.durham.sch.uk) has further information about different aspects of school life.

Informal visits from interested candidates are welcomed prior to the closing date. Please contact the school on 0191 3864612 to discuss further.